



IDEXX

SNAP[®] Test Quick Reference Guide

Table of contents

SNAP* test kits at a glance.....	3
SNAP Pro* Analyzer.....	4
SNAP* 4Dx* Plus Test.....	5
SNAP* FIV/FeLV Combo Test.....	6
SNAP* cPL Test.....	7
SNAP* fPL Test.....	8
SNAP* Parvo Test.....	9
SNAP* <i>Giardia</i> Test.....	10
SNAP* Feline proBNP Test.....	11
SNAP* Lepto Test.....	12
SNAP* Foal IgG Test.....	13
SNAP* <i>Leishmania</i> Test.....	14
Angio Detect* Test.....	15

Key



Supported species.



Read time in minutes.



Store at room temperature or in refrigerator.



Store in refrigerator.

ALL components MUST be at room temperature before the test is run.

SNAP test kits at a glance

Test name [†]	Supported sample types				Storage* Refrigerated = 2°C–8°C Room temperature = 2°C–25°C	Sample size	Drops of solution	Read time (minutes)
	Fecal	Anticoagulated whole blood	Plasma	Serum				
SNAP [®] 4Dx [®] Plus Test		●	●	●	Refrigerated until expiration, or room temperature for 6 mos	3 drops	4	8
SNAP [®] FIV/FelV Combo Test		●	●	●		Refrigerated until expiration	3 drops	4
SNAP [®] cPL Test				●	3 drops		4	10
SNAP [®] fPL Test				●	3 drops		4	10
SNAP [®] Parvo Test	●				Room temperature until expiration		Coat entire swab tip with a thin layer of fecal material.	5
SNAP [®] <i>Giardia</i> Test	●				Refrigerated until expiration	Coat entire swab tip with a thin layer of fecal material.	5	8
SNAP [®] Feline proBNP Test			●	●		3 drops	5	10
SNAP [®] Lepto Test				●		3 drops	4	10
SNAP [®] Foal IgG Test		●	●	●		1 drop	Entire bottle, or until well is full	7
SNAP [®] <i>Leishmania</i> Test		●	●	●	Refrigerated until expiration	2 drops	6 drops	6
Angio Detect Test			●	●	Room temperature until expiration	3 drops	3 drops	15

*Refer to package insert for complete storage requirements.

†Before beginning any test, refer to the package insert for complete instructions.

SNAP Pro* Analyser



- With ProRead software, your SNAP tests take care of themselves
- The SNAP Pro Analyser automatically activates, times, and interprets your SNAP test results for you.
- View interpreted results at a glance for quick, accurate health assessments and better staff efficiency.
- Connect for the benefits of two-way integration: reduce missed charges and automatically include results in your patients' medical records.

IMPORTANT: Prepare the SNAP test, but do not activate the test.*

When prompted by the SNAP Pro, gently slide the SNAP test into the port at the bottom of the analyser (well end first) until it clicks into position.

When analysis is complete, results are shown on the results screen and are saved on the analyser automatically. The color of the status light indicates the results of the run:



Solid green

All results are negative.



Flashing blue

At least one result is positive.



Flashing yellow

Visual confirmation needed.
(See operator's guide for more information).



Wrong



Right

Interpreting SNAP Pro icons

Icon	Description
	Wireless (Wi-Fi) signal status (5 gray bars = best signal; 5 red bars = no signal)
	Lost Wi-Fi communication
	Connected and communicating with the IDEXX VetLab® Station via a wired connection (red icon indicates the analyzer is off-line)
	Lost Ethernet connection
	Battery charging

Icon	Description
	Software upgrade is available (SmartService® Solutions customers only)
	Warning notification (gray icon indicates the warning has been viewed and is unresolved)
	Error notification (gray icon indicates the error has been viewed and is unresolved)
	Lost communication with IDEXX VetLab Station

For more information or to order this product, visit:

idexx.se/snappro, idexx.no/snappro, idexx.dk/snappro, idexx.fi/snappro

*Before beginning any test, refer to the package insert for complete instructions.

SNAP[®] 4Dx[®] Plus Test

Screen dogs annually for six vector-borne disease causing pathogens.



Can be stored at room temperature for 6 mos.*

Test procedure†



1. Using the provided pipette, dispense **3 drops of sample** and **4 drops of conjugate** into the sample tube.
2. Gently **invert 3–5 times** to mix.
3. Pour the entire contents of the sample tube into the sample well of a SNAP 4Dx Plus device.
4. Use the SNAP Pro[®] Analyzer to automatically activate the SNAP test and interpret the result.
OR
When color **first** appears in the activation circle, press firmly to activate. You will hear a distinct “snap.”
5. Read the result at **8 minutes**.

Whole blood[§], serum,
or plasma sample

Positive control

E. canis/E. ewingii Ab

B. burgdorferi Ab

A. phagocytophilum/

A. platys Ab

D. immitis Ag

For more information or to order this test, visit:

idexx.se/snap, idexx.no/snap, idexx.dk/snap, idexx.fi/snap

*Tests expire after 6 mos at room temperature. If not stored at room temperature, tests can be refrigerated until expiration date. Refer to package insert for complete storage requirements.

†Before beginning any test, refer to the package insert for complete instructions.

§Anticoagulated whole blood (e.g., EDTA, heparin).

SNAP[®] FIV/FeLV Combo Test

Test all new-to-household, at-risk, and symptomatic cats for feline immunodeficiency virus (FIV) and feline leukemia virus (FeLV).



Test procedure*

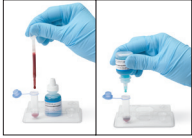

1. Using the provided pipette, dispense **3 drops of sample** and **4 drops of conjugate** into the sample tube.
2. Gently **invert 3–5 times** to mix.
3. Pour the entire contents of the sample tube into the sample well of a SNAP FIV/FeLV Combo device.
4. Use the SNAP Pro[®] Analyzer to automatically activate the SNAP test and interpret the result.
OR
When color **first** appears in the activation circle, press firmly to activate. You will hear a distinct “snap.”
5. Read the result at **10 minutes**.

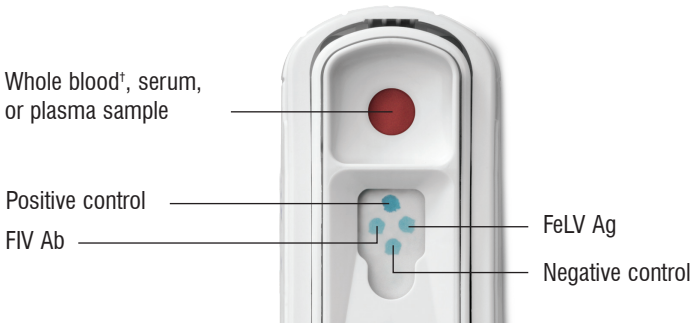

For more information or to order this test, visit:

idexx.se/snap, idexx.no/snap, idexx.dk/snap, idexx.fi/snap

*Before beginning any test, refer to the package insert for complete instructions.

[†]Anticoagulated whole blood (e.g., EDTA, heparin)

SNAP[®] cPL Test

Test dogs that present with vomiting, anorexia, and/or abdominal pain.



Test procedure*



1. Using the provided pipette, dispense **3 drops of sample** and **4 drops of conjugate** into the sample tube.



2. Gently **invert 3–5 times** to mix.



3. Pour the entire contents of the sample tube into the sample well of a SNAP cPL device.



4. Use the SNAP Pro[®] Analyzer to automatically activate the SNAP test and interpret the result.

OR

When color **first** appears in the activation circle, press firmly to activate. You will hear a distinct “snap.”



5. Read the result at **10 minutes**.

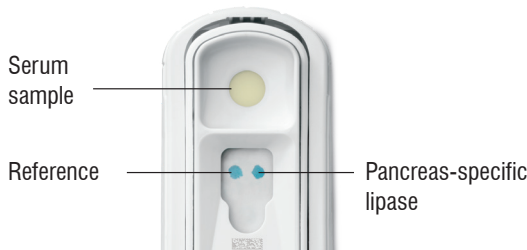

Abnormal

Sample spot is the same color or darker than reference spot.



Normal

Sample spot is lighter than reference spot.

For more information or to order this test, visit:

idexx.se/snap, idexx.no/snap, idexx.dk/snap, idexx.fi/snap

*Before beginning any test, refer to the package insert for complete instructions.

SNAP[®] fPL Test

Test cats that present with lethargy, decreased appetite, dehydration, weight loss, vomiting, and/or diarrhea.



Test procedure*



1. Using the provided pipette, dispense **3 drops of sample** and **4 drops of conjugate** into the sample tube.



2. Gently **invert 3–5 times** to mix.



3. Pour the entire contents of the sample tube into the sample well of a SNAP fPL device.



4. Use the SNAP Pro[®] Analyzer to automatically activate the SNAP test and interpret the result.

OR

When color **first** appears in the activation circle, press firmly to activate. You will hear a distinct “snap.”



5. Read the result at **10 minutes**.

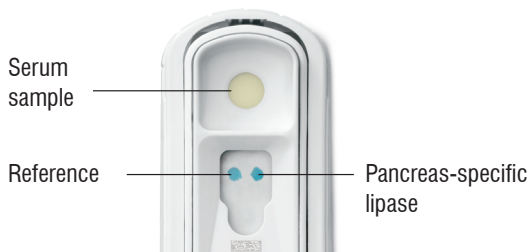

Abnormal

Sample spot is the same color or darker than reference spot.



Normal

Sample spot is lighter than reference spot.

For more information or to order this test, visit :

idexx.se/snap, idexx.no/snap, idexx.dk/snap, idexx.fi/snap

*Before beginning any test, refer to the package insert for complete instructions.

SNAP[®] Parvo Test

Test dogs that present with sudden onset of lethargy, vomiting, fever, and diarrhea.



Can be stored at room temperature.*

Test procedure†



1. Swab sample‡ and place swab tip into tube. Bend bulb to break seal and release conjugate.



2. Squeeze and release bulb **3 times** to mix sample and conjugate.



3. Squeeze bulb to dispense **5 drops** into the sample well of a SNAP Parvo device.



4. Use the SNAP Pro[®] Analyzer to automatically activate the SNAP test and interpret the result.

OR

When color **first** appears in the activation circle, press firmly to activate. You will hear a distinct “snap.”



5. Read the result at **8 minutes**.

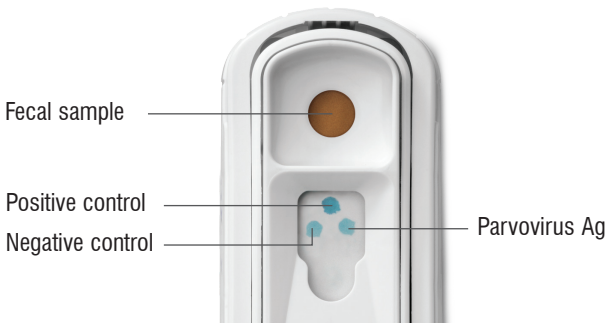

For more information or to order this test, visit:

idexx.se/snap, idexx.no/snap, idexx.dk/snap, idexx.fi/snap

*Refer to package insert for complete storage requirements.

†Before beginning any test, refer to the package insert for complete instructions.

‡The collection swab is not intended to be used rectally.

SNAP[®] Giardia Test

Test dogs and cats that present with diarrhea.



Test procedure*



1. Swab sample[†] and place swab tip into tube. Bend bulb to break seal and release conjugate.



2. Squeeze and release bulb **3 times** to mix sample and conjugate.



3. Squeeze bulb to dispense **5 drops** into the sample well of a SNAP Giardia device.



4. Use the SNAP Pro Analyzer to automatically activate the SNAP test and interpret the result.

OR

When color **first** appears in the activation circle, press firmly to activate. You will hear a distinct "snap."



5. Read the result at **8 minutes**.



For more information or to order this test, visit:

idexx.se/snap, idexx.no/snap, idexx.dk/snap, idexx.fi/snap

*Before beginning any test, refer to the package insert for complete instructions.

†The collection swab is not intended to be used rectally.

SNAP[®] Feline proBNP Test

Test cats at risk for cardiac disease (murmur, arrhythmia, respiratory signs, prior to anesthesia, breed, history, age).



Test procedure*



1. Using the provided pipette, dispense **3 drops of sample** and **5 drops of green conjugate** into the sample tube.



2. Gently **invert 3–5 times** to mix.



3. Pour the entire contents of the sample tube into the sample well of a SNAP Feline proBNP device.



4. Use the SNAP Pro[®] Analyzer to automatically activate the SNAP test and interpret the result.

OR

When color **first** appears in the activation circle, press firmly to activate. You will hear a distinct “snap.”



5. Read the result at **10 minutes**.

Serum or EDTA plasma sample

Reference

NT-proBNP

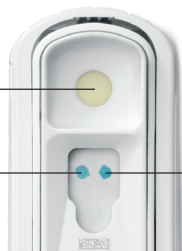

Abnormal

Sample spot is the same color or darker than reference spot.



Normal

Sample spot is lighter than reference spot.

For more information or to order this test, visit:

idexx.se/snap, idexx.no/snap, idexx.dk/snap, idexx.fi/snap

*Before beginning any test, refer to the package insert for complete instructions.

SNAP[®] Lepto Test

Test dogs when leptospirosis is suspected.



Test procedure*



1. Using the provided pipette, dispense **3 drops of sample** and **4 drops of conjugate** into the sample tube.



2. Gently **invert 3–5 times** to mix.



3. Pour the entire contents of the sample tube into the sample well of a SNAP Lepto device.



4. Use the SNAP Pro[®] Analyzer to automatically activate the SNAP test and interpret the result.

OR

When color **first** appears in the activation circle, press firmly to activate. You will hear a distinct “snap.”



5. Read the result at **10 minutes**.

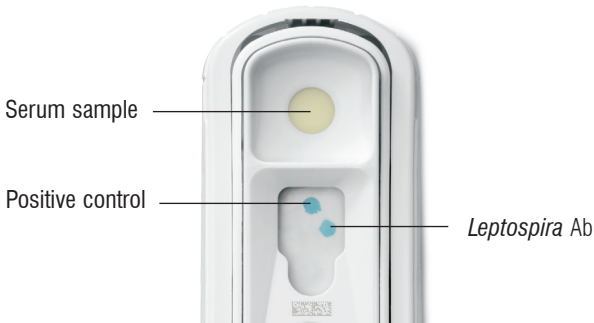

For more information or to order this test, visit:

idexx.se/snap, idexx.no/snap, idexx.dk/snap, idexx.fi/snap

*Before beginning any test, refer to the package insert for complete instructions.

SNAP[®] Foal IgG Test

Test foals for immunoglobulin G (IgG) levels.



Test procedure*

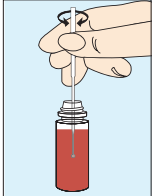

1. Dilute sample.†
Mix thoroughly and dispose of the first **5–10 drops** from the bottle.

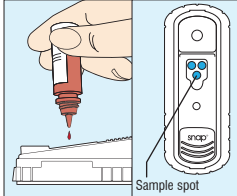

2. Apply **1 drop** of sample over sample spot.

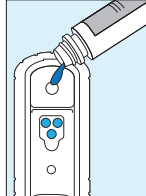

3. Pour the entire bottle of conjugate into the sample well.



4. When color **first** appears in the activation circle, press firmly to activate. You will hear a distinct “snap.”



5. Read the result at **7 minutes.**

Whole blood†, serum, or plasma sample

400 mg/dL calibrator spot

Sample spot

800 mg/dL calibrator spot

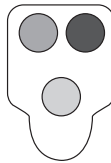
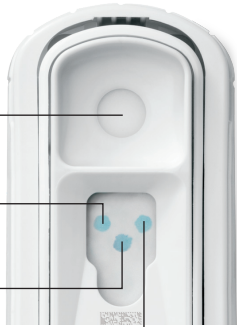

≤ 400 mg/dL IgG

Color intensity of sample spot is lighter than or equal to the 400 mg/dL calibrator spot.

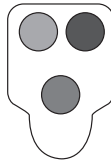

400–800 mg/dL IgG

Color intensity of sample spot is darker than the 400 mg/dL calibrator spot but lighter than or equal to the 800 mg/dL calibrator spot.

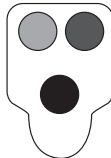

> 800 mg/dL IgG

Color intensity of sample spot is darker than the 800 mg/dL spot.

For more information or to order this test, visit:

idexx.se/snap, idexx.no/snap, idexx.dk/snap, idexx.fi/snap

*Before beginning any test, refer to the package insert for complete instructions.

†Anticoagulated whole blood (e.g., EDTA, heparin), serum, or plasma sample.

SNAP[®] Leishmania Test

Test dogs when leishmaniasis is suspected.



Test procedure*



1. Using the provided pipette, dispense **2 drops of sample** and **6 drops of conjugate** into the sample tube.



2. Gently **invert 3–5 times** to mix.



3. Pour the entire contents of the sample tube into the sample well of a SNAP Leishmania device.



4. Use the SNAP Pro[®] Analyzer to automatically activate the SNAP test and interpret the result.

OR

When color **first** appears in the activation circle, press firmly to activate. You will hear a distinct “snap.”



5. Read the result at **6 minutes**.

Whole blood[†], serum,
or plasma sample

Positive control

Negative control

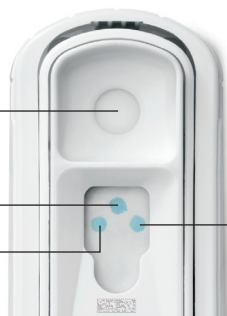

Leishmania sample spot

For more information or to order this test, visit:

idexx.se/snap, idexx.no/snap, idexx.dk/snap, idexx.fi/snap

*Before beginning any test, refer to the package insert for complete instructions.

[†]Anticoagulated whole blood (e.g., EDTA, heparin)

Angio Detect* Test

Detects Angiostrongylus vasorum antigen in dogs.



Can be stored at room temperature.*

Test procedure*

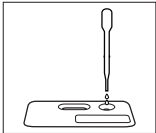

1. Using the provided pipette, dispense **3 drops of sample** into the sample well (S) until it is completely absorbed.

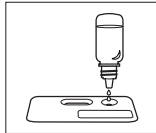

2. Remove the blue cap only from the test buffer bottle, leaving the white cap firmly attached. Then hold the buffer bottle vertically and add **3 drops of buffer** to the circular sample well.

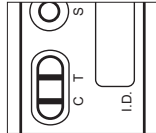

3. Read the result at **15 minutes**.

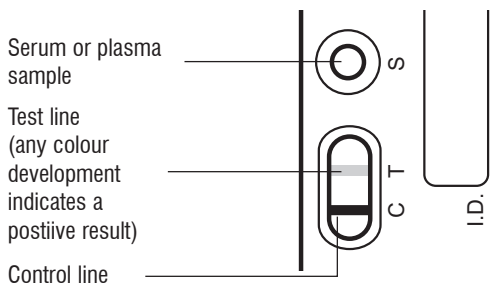

For more information or to order this test, visit:

idexx.se/snap, idexx.no/snap, idexx.dk/snap, idexx.fi/snap

*Before beginning any test, refer to the package insert for complete instructions.

Have questions?

Contact IDEXX Customer and Technical Support at:

Sweden

Phone: 08 51 989566

Email: CS-Sweden@idexx.com

Norway

Phone: 24 05 51 10

Email: CS-Norway@idexx.com

Denmark

Phone: 433 10439

Email: CS-Denmark@idexx.com

Finland

Phone: 09 7252 2253

Email: CS-Finland@idexx.com

